

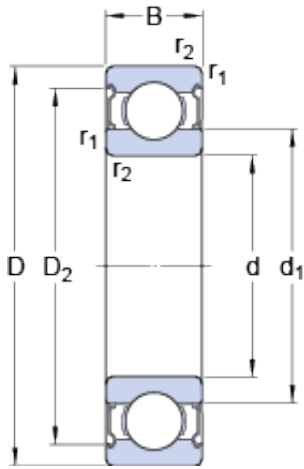

# EYA Bearing Roller Industry Co.,Ltd



6006-2Z Bearing 2D drawings and 3D CAD models

## SKF 6006-2Z deep groove ball bearings

Bearing No. 6006-2Z

Size	55x30x13 mm
Bore Diameter	55 mm
Outer Diameter	30 mm
Width	13 mm
d	30 mm
D	55 mm
B	13 mm
d <sub>1</sub>	38.2 mm
D <sub>2</sub>	49 mm
r <sub>1,2</sub> - min.	1 mm
d <sub>a</sub> - min.	34.6 mm
d <sub>a</sub> - max.	38.1 mm
D <sub>a</sub> - max.	50.4 mm
r <sub>a</sub> - max.	1 mm
Basic dynamic load rating - C	13.8 kN
Basic static load rating - C <sub>0</sub>	8.3 kN
Fatigue load limit - P <sub>u</sub>	0.355 kN
Reference speed	28000 r/min
Limiting speed	14000 r/min
Calculation factor - k <sub>r</sub>	0.025
Calculation factor - f <sub>0</sub>	15
Category	Single Row Ball Bearings
Inventory	0.0
Manufacturer Name	SKF
Minimum Buy Quantity	N/A



## EYA Bearing Roller Industry Co.,Ltd

Weight / Kilogram	0.127
EAN	7316571408835
Product Group	B00308
Enclosure	2 Metal Shields
Precision Class	ABEC 1   ISO P0
Maximum Capacity / Filling Slot	No
Rolling Element	Ball Bearing
Snap Ring	No
Internal Special Features	No
Cage Material	Steel
Internal Clearance	C0-Medium
Inch - Metric	Metric
Long Description	30MM Bore; 55MM Outside Diameter; 13MM Outer Race Diameter; 2 Metal Shields; Ball Bearing; ABEC 1   ISO P0; No Filling Slot; No Snap Ring; No Internal Special Features
Category	Single Row Ball Bearing
UNSPSC	31171504
Harmonized Tariff Code	8482.10.50.68
Noun	Bearing
Keyword String	Ball
Manufacturer URL	<a href="http://www.skf.com">http://www.skf.com</a>
Manufacturer Item Number	6006-2Z
Weight / LBS	0.28
Bore	1.181 Inch   30 Millimeter
Outer Race Width	0.512 Inch   13 Millimeter
Outside Diameter	2.165 Inch   55 Millimeter
d <sub>1</sub>	38.2 mm
D <sub>2</sub>	49 mm
r <sub>1,2</sub> min.	1 mm



## EYA Bearing Roller Industry Co.,Ltd

$d_a$ min.	34.6 mm
$d_a$ max.	38.1 mm
$D_a$ max.	50.4 mm
$r_a$ max.	1 mm
Basic dynamic load rating C	13.8 kN
Basic static load rating $C_0$	8.3 kN
Fatigue load limit $P_u$	0.355 kN
Calculation factor $k_r$	0.025
Calculation factor $f_0$	15
Mass bearing	0.12 kg